

WB750 GR



Worm gear winch

Hand operated worm gear winch:

- robust and safe hoisting and pulling (aprox. 2.5x hoisting cap.) winch
- static safety factor of 4
- thin webbing belt instead of cable makes the winch very compact
- winch is enclosed belt
- belt exit to the top, bottom or through the backplate
- square worm-wormwheel transmission and maintenance free bearing
- adjustable crank, with ergonomic plastic grip
- easy to grease worm-wormwheel transmission
- load pressure brake with quiet double ratchet system
- standard paint finish 1 layer (60 - 80 Micron), or zinc-plated finish (6 - 8 Micron)
- in compliance with EN 13157 and DIN15020

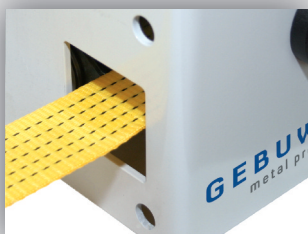

Technical specifications WB750 GR

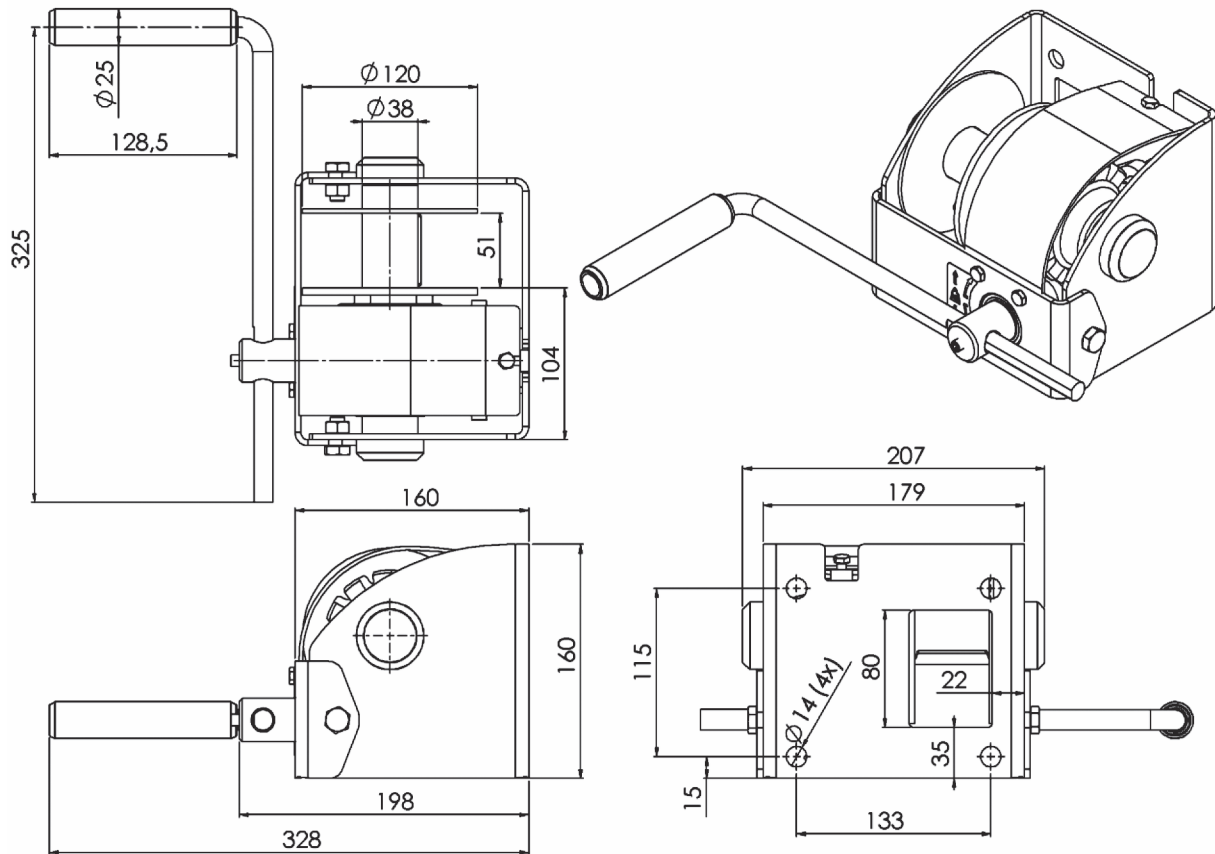

Type	Mounting	Material	Remarks
WB750 GR	Wall, 4x M12 class 8.8	Painted finish	RAL 7035 (grey)
WB750 EV	Wall, 4x M12 class 8.8	Zinc-plated finish	

Technical specifications	WW750
Capacity:	
1 st belt layer	750 kg
Last belt layer	350 kg
Crankforce 1 st belt layer position	11 daN
Hoisting length by one rotation of the crank, 1 st layer	12 mm
Max. belt storage	5 m
Width belt	Max. 50 mm
Min. breaking load belt	37,5 kN
Own weight	9 kg