

**CRMA**

30-100 ton  
Stroke 50-150 mm  
700 bar

**CRMA**  
Series

## Aluminium, single-acting cylinders with spring return



- Built with special high-strength aluminium alloy.
- Lightweight cylinders that are easy to carry and very easy to handle. Used in applications in which reduced weight is an important factor.
- Spring-actuated return. Designed to operate in any position.
- Steel baseplate to prevent the cylinder from deforming if used on surfaces that are not perfectly flat.
- The stop ring guarantees maximum operator safety, preventing plunger over-stroke.
- The wiper reduces contamination between ring and rod.
- High-strength removable head, concentrically splined to distribute the load uniformly over the entire surface.

**SPECIAL CYLINDERS  
ON REQUEST**



*CRMA 50/150 to lift a press section.*

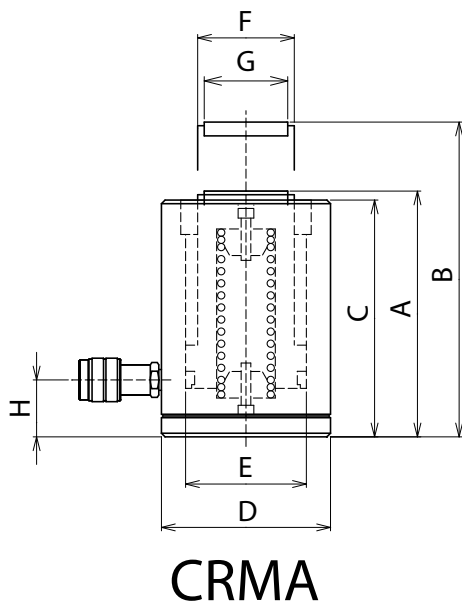

**Various aluminium cylinder models are also available**

- CSEA single-acting cylinders with load return.

Models in stock:  
CSEA-15/125  
CSEA-25/125  
CSEA-35/130

- CRIA double-acting cylinders with oil return.
- CRMAFO hollow, single-acting cylinders with spring return.

CAP/Force ton (kN)	STROKE mm	MODEL	SECTION cm <sup>2</sup>	VOLUME cm <sup>3</sup>	WEIGHT kg	DIMENSIONS in mm							
						A	B	C	D	E	F	G	H
<b>30</b> /309.3	50	CRMA-30/50	44.2	220.9	5.3	170	220	166	120	75	60	52	40
	100	CRMA-30/100	44.2	441.8	6.6	220	320	216	120	75	60	52	40
<b>50</b> /496.2	50	CRMA-50/50	70.9	354.4	9.7	178	228	174	149	95	80	72	45
	100	CRMA-50/100	70.9	708.8	11.9	226	326	222	149	95	80	72	45
	150	CRMA-50/150	70.9	1063.2	14.2	276	426	272	149	95	80	72	45
<b>100</b> /1002	50	CRMA-100/50	143.1	715.7	19	192	242	188	198	135	110	92	50
	100	CRMA-100/100	143.1	1431.4	23	247	347	243	198	135	110	92	50
	150	CRMA-100/150	143.1	2147.1	28	307	457	303	198	135	110	92	50

*Cylinders with higher tonnage and different strokes are also available.*